

Installation Instructions



Arcos Medium and Large

DO NOT REMOVE THE LED ASSEMBLY. THIS WILL VOID THE WARRANTY. Call Zumtobel at 1-800-448-4131 for questions

RISK OF FIRE AND ELECTRICAL SHOCK

Contact, improper installation, or improper servicing MAY RESULT IN DEATH OR SERIOUS INJURY! Fixture must be installed by a qualified electrician only. Fixture is intended for installation in accordance with the National Electrical Code, local and federal code specifications. Disconnect power at electrical panel before servicing. Retain these instructions for maintenance reference.

ADVERTENCIA: Riesgo de incendio o impacto eléctrico.

Conexión, instalación inapropiada o servicio incorrecto PUEDE CAUSAR MUERTE O HERIDAS GRAVES. La luminaria debe ser instalada únicamente por un eléctrico calificado. La luminaria debe instalarse de acuerdo al Norma eléctrica nacional, al igual que especificaciones locales y normas federales. Se debe desconectar la corriente eléctrica antes de realizar la mantención. Conservar estas instrucciones como referencia para futuras mantenciones.

ATTENTION : RISQUE D'INCENDIE ET D'ELECTROCUTION.

Une installation, un entretien ou un contact physique non conforme pourraient mener à un DANGER DE MORT OU DE BLESSURE GRAVE! L'appareil doit être installé uniquement par un électricien professionnel qualifié. L'installation doit respecter le code électrique national de même que les lois locales et fédérales en vigueur. Veuillez fermer l'alimentation électrique au panneau principal avant tout entretien. Conservar ces instructions pour référence et tout entretien futur.

The following installation instructions relate to the options below

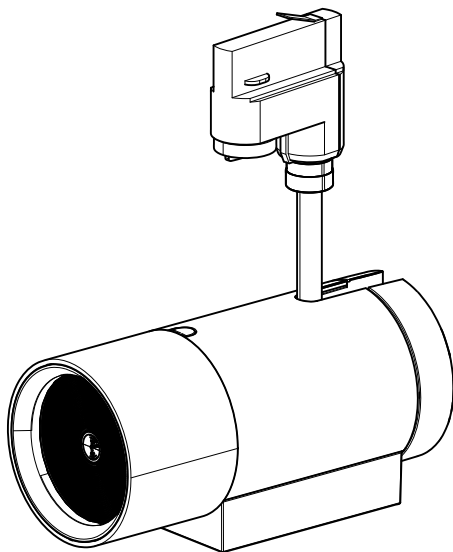

Arcos Medium

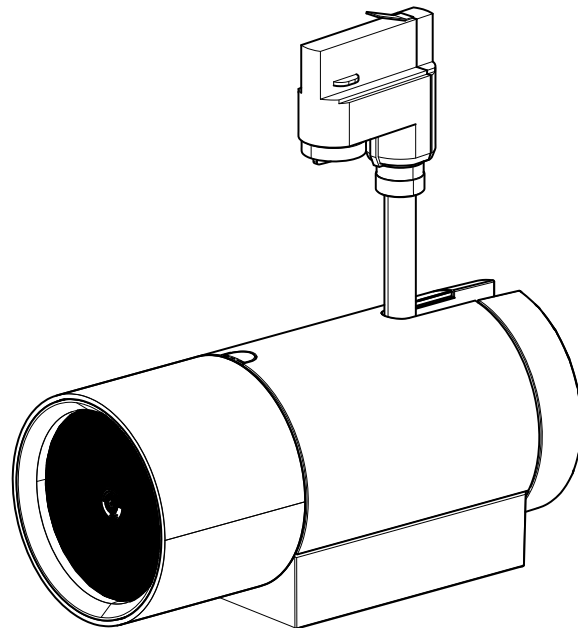

Arcos Large

Fixture does not include Global Trac® system. This may be ordered separately through Zumtobel

Installation Instructions



Arcos Medium and Large

DO NOT REMOVE THE LED ASSEMBLY. THIS WILL VOID THE WARRANTY. Call Zumtobel at 1-800-448-4131 for questions

Global Trac® Installation

Two Circuit

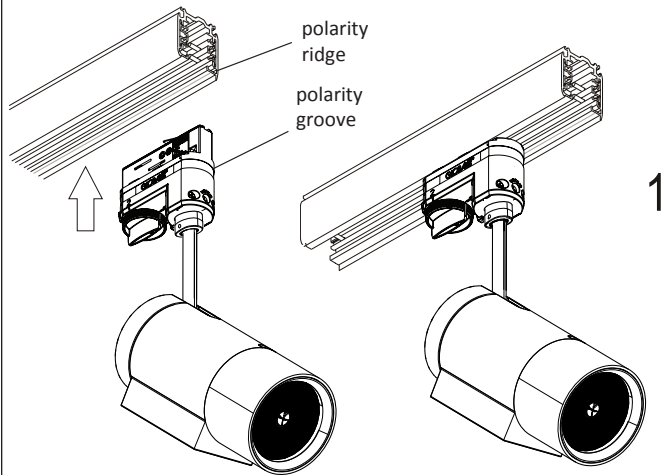

1 Insert fixture into track. The fixture adapter is inserted with the polarity groove towards the polarity ridge on the track. Push the adapter into the track until it snaps into place.

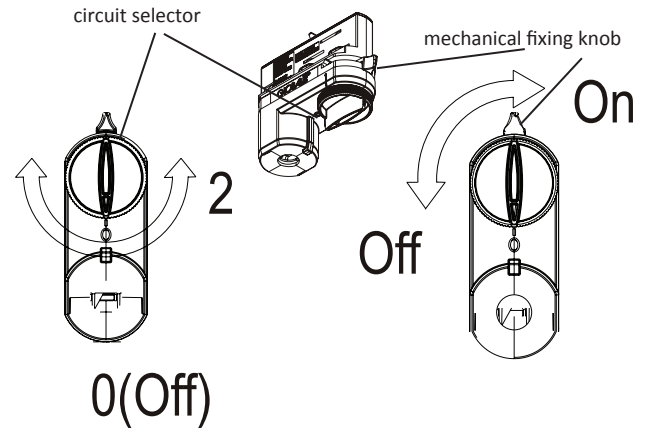

2 Turn the mechanical fixing knob clockwise to secure fixture into place.
3 Select the desired circuit with the circuit selector knob (1-0-2).

* TEK 120V Track Install Only

Installation Instructions

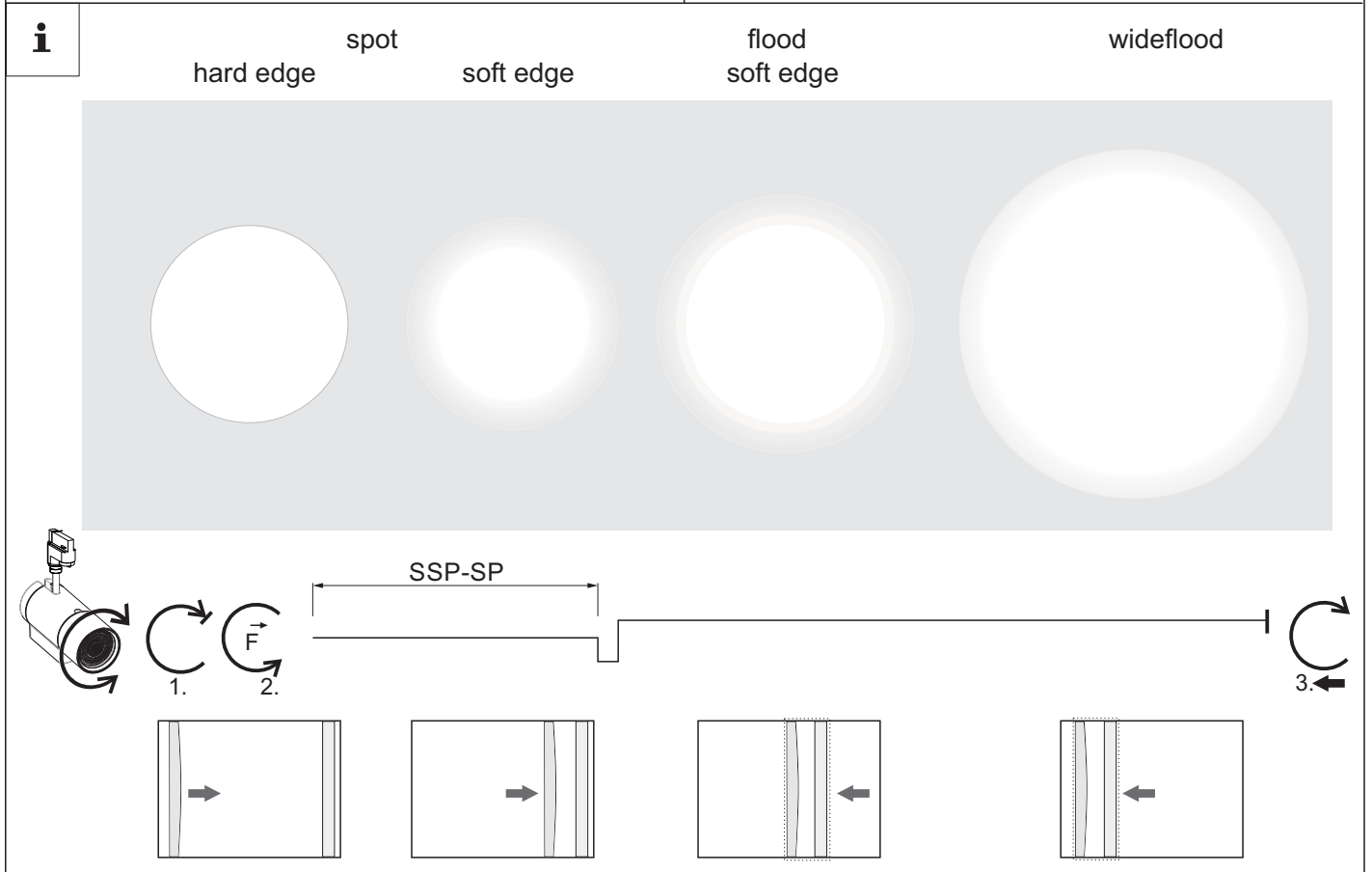
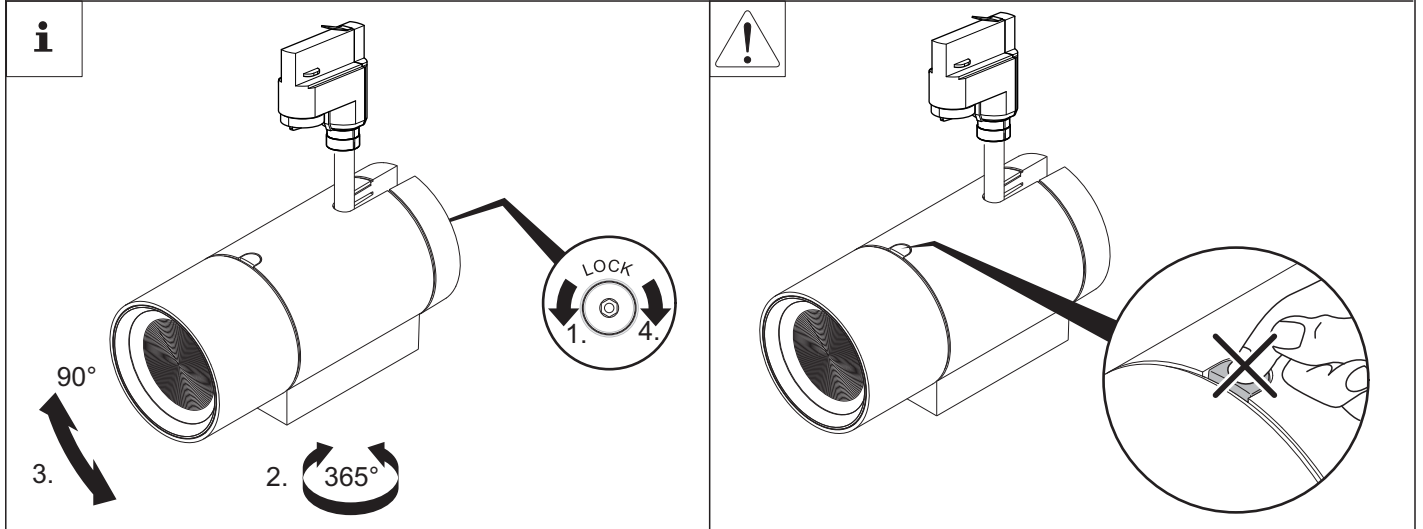
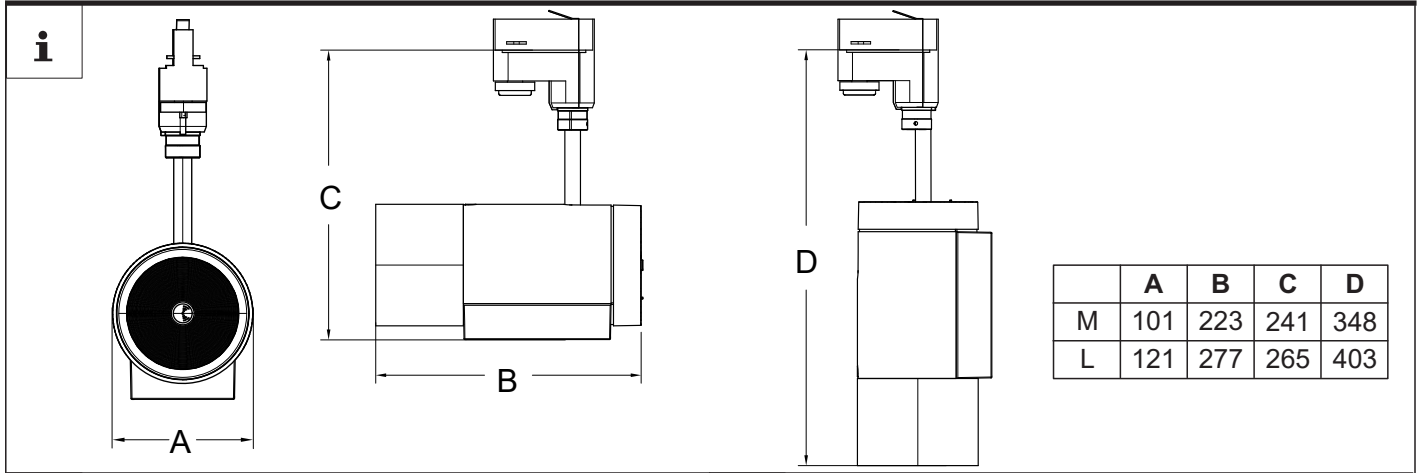

Installation Instructions

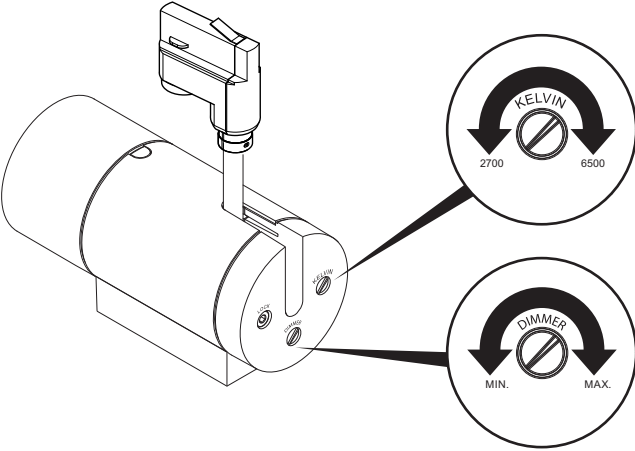
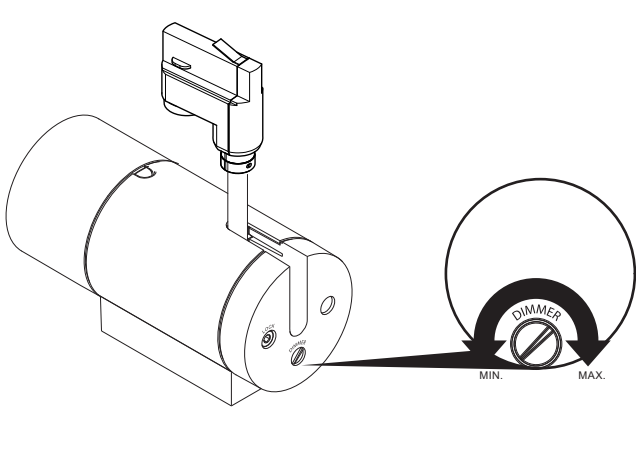
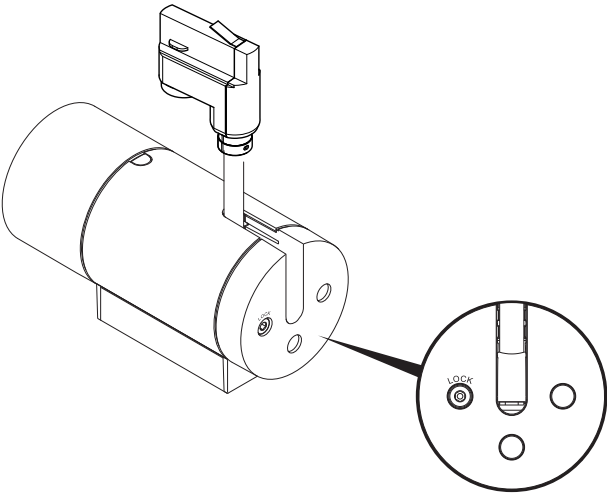
<p>i DIM (900)</p>  <p>The diagram shows a perspective view of the DIM (900) fixture with a callout to its control panel. The panel features two rotary dials. The top dial is labeled 'KELVIN' and has arrows indicating a range from 2700 to 6500. The bottom dial is labeled 'DIMMER' and has arrows indicating a range from 'MIN.' to 'MAX.'.</p>	<p>i DIM (930/940)</p>  <p>The diagram shows a perspective view of the DIM (930/940) fixture with a callout to its control panel. The panel features a single rotary dial labeled 'DIMMER' with arrows indicating a range from 'MIN.' to 'MAX.'.</p>
<p>i Wireless</p>  <p>The diagram shows a perspective view of the Wireless fixture with a callout to its control panel. The panel features a single rotary dial labeled 'LOCK'.</p>	